

# **meaden**

---

## **Standard Split Rings & New Generation Tooling**



**meaden**  
Products for the Printing Industry  
210 West 83rd Street  
Burr Ridge, Illinois 60527  
Telephone: 630/655-0888  
FAX: 630/655-3012  
Internet [http:// www.meaden.com](http://www.meaden.com)

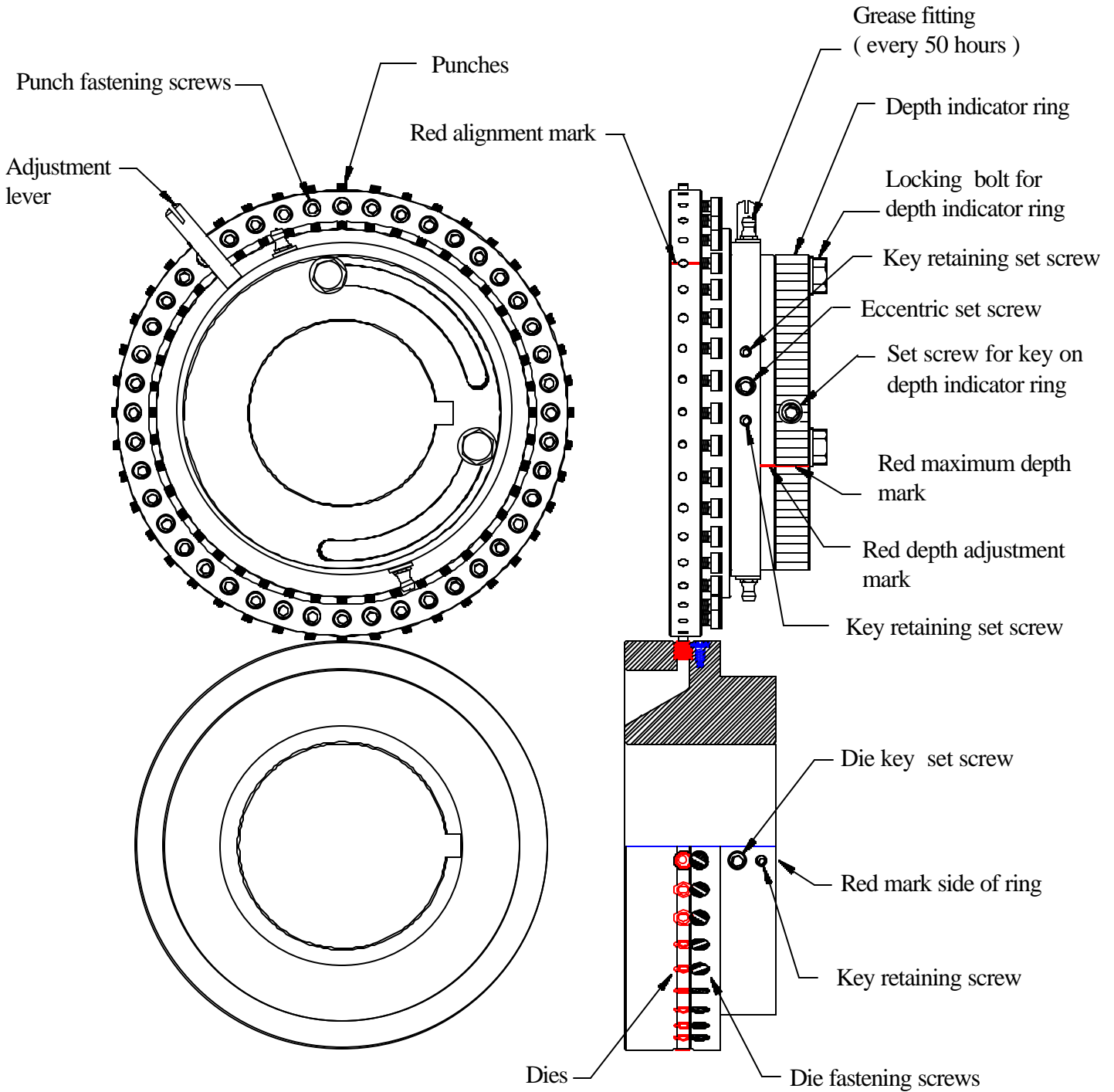

# Single Row BTR Punch Ring

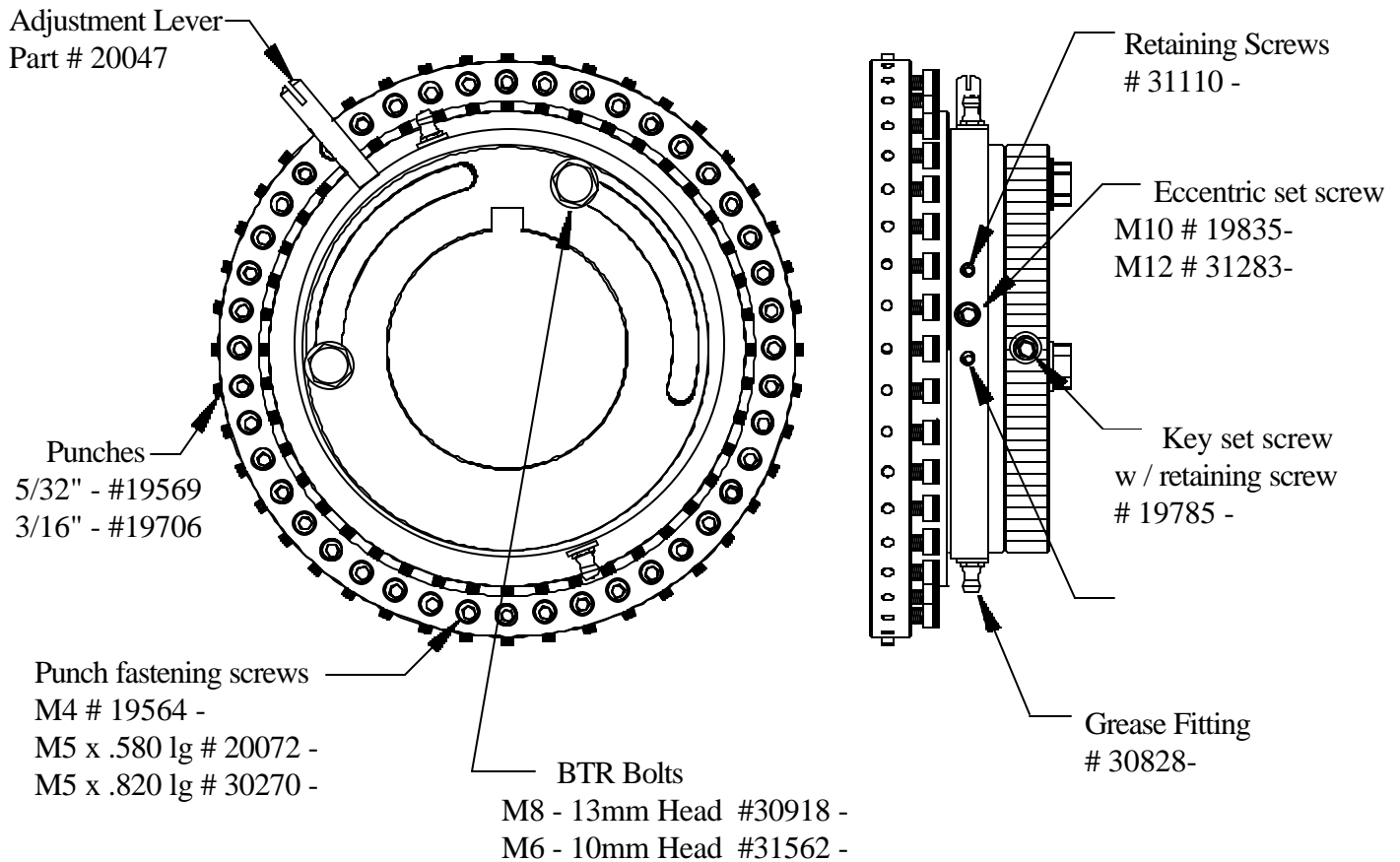

### Single Row Die Ring

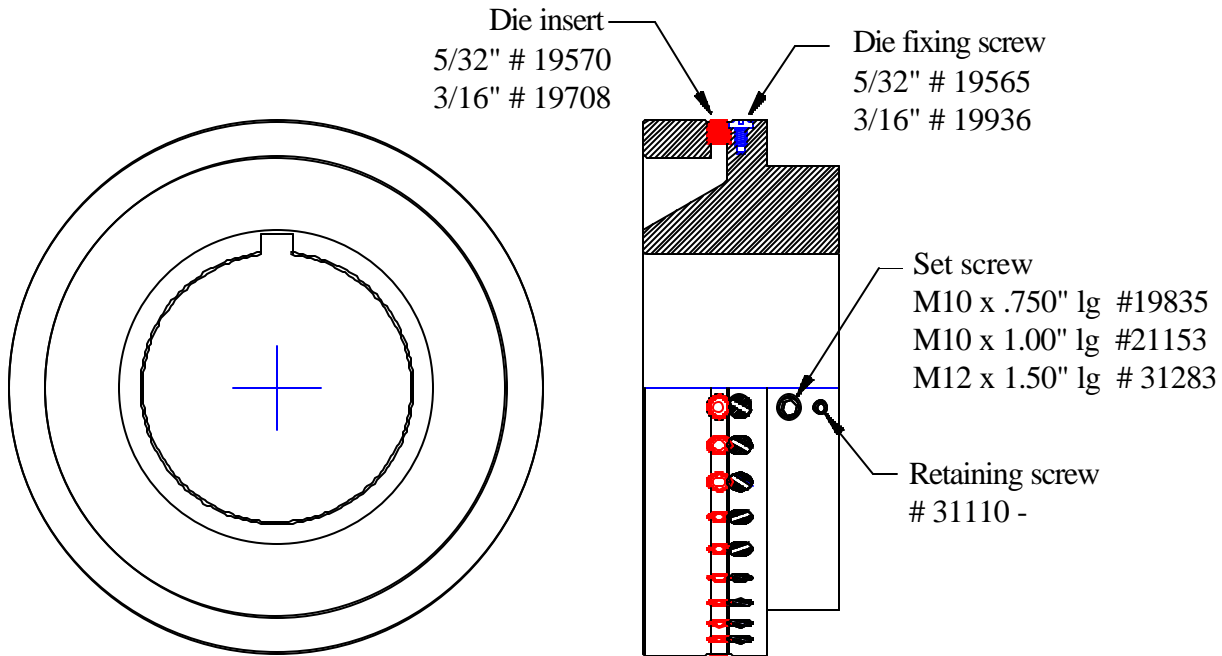

## Punches & Dies for New Generation Tooling

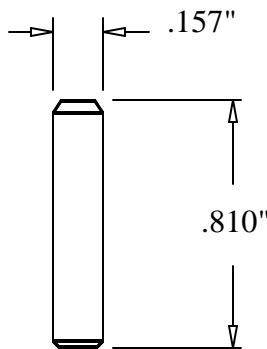
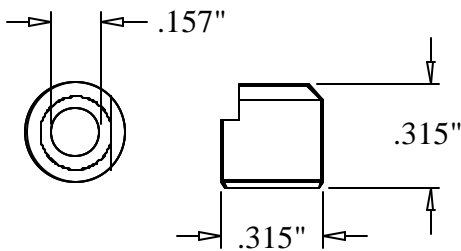
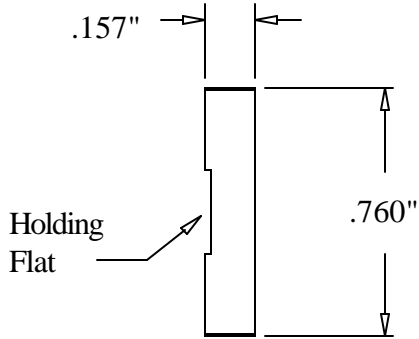

Set up punch  
19701

Part Number	Hole Size	Diameter	Length	Notes
New Generation Punches				
19452	.157"	.157"	.760"	HSS Punch
19569	.157"	.157"	.760"	Long Life Punch
19297	.157"	.157"	.760"	Carbide Punch
19701	.157"	.157"	.810"	Setup Punch
19706	.188"	.157"	.760"	Long Life Punch
30281	.188"	.157"	.810"	Setup Punch
New Generation Dies				
19295	.157"	.315"	.315"	HSS Die
19570	.157"	.315"	.315"	Long Life Die
19296	.157"	.315"	.315"	Carbide Die
19708	.188"	.315"	.315"	Long Life Die

## Spare Parts for

## New Generation Tooling

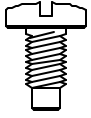

5/32" Line Hole  
Die Screw  
19565

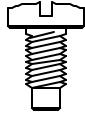

3/16" Line Hole  
Die Screw  
19936

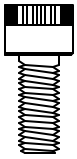

5/32" Line Hole  
Punch Screw  
19564

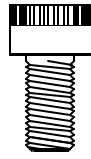

5/32" Line Hole  
Punch Screw  
20072

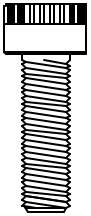

\* 5/32" Line Hole  
Punch Screw  
30270

Part Number	Head	Thread	Length	Price	Notes
19565	Slot	M4	.430"	\$0.25 ea	5/32" die screw
19936	Slot	M4	.430"	\$0.70 ea	3/16" die screw
19564	3.0 mm	M4	.545"	\$0.25 ea	punch screw
20072	4.0 mm	M5	.580"	\$0.35 ea	punch screw
30270	4.0 mm	M5	.820"	\$0.40 ea	punch screw

\*\*Only for 33", 34" and 36" Single row punch rings

### Punch & Die Puller

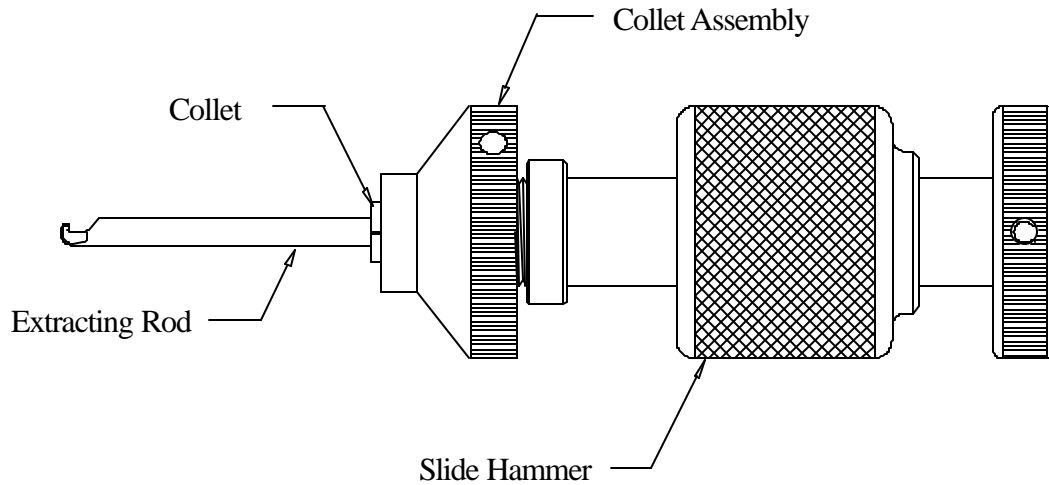

Part Number	Description
30952	Complete Assembly for 5/32" size punch & die
30953	Complete Assembly for 3/16" size punch & die
20582	Complete Puller with only 5/32" punch collet
30954	Complete Puller with only 3/16" punch collet
20588	Spare collet for 5/32" punches
30526	Spare collet for 3/16" punches
21119	Collet for 5/ 32" die extracting rod
30707	Collet for 3/16" die extracting rod
21115	Extracting rod for 5/32" dies
21118	Extracting rod for 3/16" dies

## Spare Parts for New Generation Tool Kit

Part Number	Description	Qty.
19618	Complete New Generation Tool Kit	
** denotes included in tool kit		
** 32253	warning label	1
** 20072	M5 Line hole punch screws	50
** 19565	M4 Line hole die screws	50
** 20046	Torque wrench for NG Tooling w/bit	1
31484	4 mm Insert bit - Torque Wrench	
31879	5/32" Insert bit for torque wrench	
** 19701	Setup punches for NG Tooling	2
** 30826	Grease Gun	1
** 30692	Grease cartridge	1
** 30828	Grease Fittings	2
** 30822	Brass hammer	1
** 30823	13 mm combination wrench	1
30919	10 mm combination wrench ( 17" Cir )	
** 30824	Screwdriver	1
** 30124	2.5 mm Hex Allen key	1
** 30829	3.0 mm Hex Allen key	1
** 30459	4.0 mm Hex Allen key	1
** 30831	5.0 mm Hex Allen key	1
** 30832	6.0 mm Hex Allen key	1
** 30827	Plastic Case	1
** 13980	Complete Meaden Die Puller	1
** 16755	Spare 5/32" Jaw for NG Tooling	1
30503	4mm Punch hole reamer	
30504	8mm Die hole reamer	
31280	feeler gage for 17 & 18" rings	
19832	feeler gage for 22" rings	
19833	feeler gage for 24" rings	
30924	feeler gage for 25.5" rings	
31568	feeler gage for 28" rings	
31569	feeler gage for 33 & 34" rings	
31570	feeler gage for 36" rings	

Split Punch and Die Rings Available for all presses

## LINE HOLES

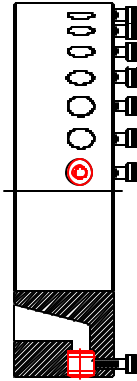
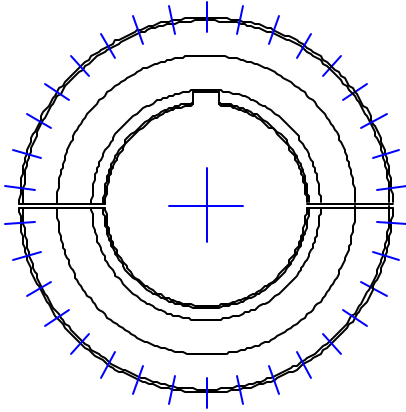

### Line Hole Rings - Split Type

#### Circumference & Type

- 17" Single Row
- 17" Double Row
- 21" Single Row
- 21" Double Row
- 22" Single Row
- 22" Double Row
- 24" Single Row
- 24" Double Row
- 25.5" Single Row
- 25.5" Double Row
- 28" Single Row
- 28" Double Row

## FILE HOLES

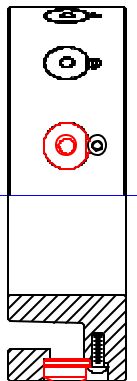
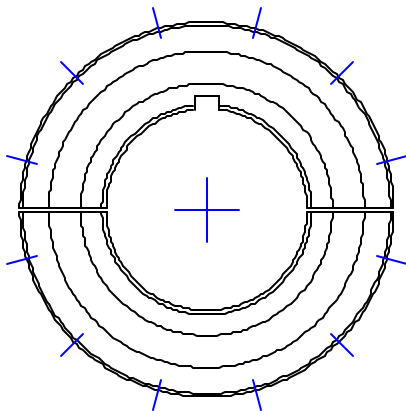

### File Hole Rings - Split Type

#### Circumference & Type

- 17" Single Row (8 holes)
- 17" Single Row (16 holes)
- 21" Single Row (12 holes)
- 21" Single Row (20 holes)
- 22" Single Row (12 holes)
- 22" Single Row (18 holes)
- 24" Single Row (12 holes)
- 24" Single Row (22 holes)
- 25.5" Single Row (12 holes)
- 25.5" Single Row (24 holes)
- 28" Single Row (12 holes)
- 28" Single Row (24 holes)